



<p>Hudson County Recording Data Page Honorable Diane Coleman Hudson County Register</p> 	<p>Official Use Only – Barcode</p>  <p>20191112010108780 1/13 11/12/2019 09:06:34 AM DEED Bk: 9448 Pg: 902 Diane Coleman</p>
<p>Official Use Only – Record & Return</p>	<p>Official Hudson County, Register of Deeds Receipt No. 1563828</p>
<p>Date of Document: September 18, 2019</p>	<p>Type of Document: Deed Notice</p>
<p>First Party Name: Honeywell International Inc.</p>	<p>Second Party Name: 425/445 Route Property LLC</p>
<p>Additional Parties:</p>	

THE FOLLOWING SECTION IS REQUIRED FOR DEEDS ONLY	
Block:	Lot:
Municipality:	
Consideration:	
Mailing Address of Grantee:	

THE FOLLOWING SECTION IS FOR ORIGINAL MORTGAGE BOOKING & PAGING INFORMATION FOR ASSIGNMENTS, RELEASES, SATISFACTIONS, DISCHARGES & OTHER ORIGINAL MORTGAGE AGREEMENTS ONLY	
Original Book:	Original Page:

HUDSON COUNTY RECORDING DATA PAGE
Please do not detach this page from the original document as it contains important recording information and is part of the permanent record.

Return Address:
Maria Kaouris - Honeywell
115 Tabor Road
Morris Plains, NJ 07950

TERMINATION OF DEED NOTICE

FILED AT THE OFFICE OF THE
REGISTER OF HUDSON
COUNTY

IN DEED BOOK 8765 Pages 187 et seq.

AS TO

BLOCK(S) 1289.5, LOT E, TAX MAP OF THE City of Jersey City, Hudson County

IN ACCORDANCE WITH N.J.S.A. 58:10B-13, THIS DOCUMENT IS TO BE RECORDED
IN THE SAME MANNER AS DEEDS ~~AND OTHER INTERESTS IN REAL PROPERTY.~~

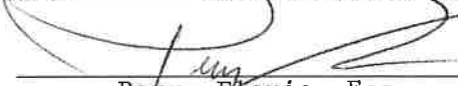
Prepared by: 
Perry Florio, Esq.

Recorded by: _____
[Signature, Officer of County Recording Office]
[Print name below signature]

This Termination of Deed Notice is made as of September 18, 2019 by Honeywell International Inc. (Honeywell) and its subsidiary 425/445 Route 440 Property LLC.

1. DEED NOTICE RECORDED IN THE OFFICE OF THE REGISTER OF HUDSON COUNTY, AT BOOK 8765, PAGES 187 et seq. By way of a Declaration of Environmental Restriction (DER) or Deed Notice (hereinafter collectively Deed Notice) dated November 30, 2010, Honeywell advised of: (a) the existence of soil contamination in concentrations at the real property situated in the City of Jersey City and designated as Block(s) 1289.5, Lot E (“the Property”) on the Tax Map of the City of Jersey City that do not allow for the unrestricted use of the Property; (b) the existence of institutional and/or engineering controls selected as part of the remedial action for the Property; and (c) the continuing obligation of Honeywell, subsequent owners, and others to monitor and maintain those institutional and/or engineering controls. The Deed Notice was part of the remediation of contamination at the Property and was recorded in the Office of the Register of Hudson County on November 30, 2010 in Deed Book 8765, Pages 187 et seq. by Honeywell, the then owner of the Property. Pursuant to Paragraph 10, the Deed Notice was to remain in effect until such time as the Department approved the termination of the Deed Notice by executing a document expressly terminating the Deed Notice.

2. TERMINATION OF DEED NOTICE RECORDED IN THE OFFICE OF THE REGISTER OF HUDSON COUNTY AT BOOK 8765, PAGES 187 et seq AS TO BLOCK(S) 1289.5, LOT(S) E. By way of letter dated July 2, 2019, Honeywell requested approval from the Department to terminate the Deed Notice because conditions that required the execution and recording of the Deed Notice no longer exist on Block(s) 1289.5, Lot(s) E. The Department approved the request by way of letter dated September 19, 2019. Accordingly, the Department hereby executes this Termination of Deed Notice. Subject to the provisions of paragraph 4

below, the Department directs that the Deed Notice recorded in the Office of the Register of Hudson County in Deed Book 8765, Pages 187 et seq. shall be terminated and discharged. A metes and bounds description of Block(s) 1289.5, Lot(s) E and a scaled map showing the boundaries of Block(s) 1289.5, Lot(s) E are attached hereto as Exhibits A and B, respectively.

3. EXECUTION OF NEW DEED NOTICE FOR BLOCK(S) 21902, Lot 1 and 26704, Lot 5 (formerly Block 1289.5, Lot E). Although the Department has determined that a change in conditions warrants the termination of the Deed Notice as to Block 1289.5, Lot E, the Department also has determined that soil contamination remains on Block 21902, Lot 1 (formerly Block 1289.5, Lot E), in concentrations that do not allow for the unrestricted use of the Property. Thus, the approved remedial action includes a new Deed Notice for Block 21902, Lot 1 (formerly Block 1289.5, Lot E). The new Deed Notice shall be executed and recorded by Honeywell and its subsidiary 425/445 Route 440 Property LLC.

4. EFFECTIVE DATE OF TERMINATION OF DEED NOTICE. This Termination of Deed Notice shall take effect on the date this Termination of Deed Notice or the date the new Deed Notice for Block 21902, Lot 1 (formerly Block 1289.5, Lot E) is recorded in the Office of the Register of Hudson County, whichever is later, or, if this Termination of Deed Notice and the new Deed Notice are simultaneously recorded in the Office of the Register of Hudson County, on the date of such simultaneous recording.

5. SIGNATURES IN WITNESS WHEREOF, Honeywell and its subsidiary 425/445 Route 440 Property LLC and the New Jersey Department of Environmental Protection have executed this Termination of Deed Notice, as of the date first written above.

WITNESS:

[Route 425/445 Route 440 LLC]

Maria Kauris
[Signature]

By: John J. Morris
[Signature]

Maria Kauris
[Print name and title of witness]

By: John J. Morris
[Print name and title]

Remediation
Manager

Global Remediation Director

STATE OF NEW JERSEY SS.:
COUNTY OF MORRIS

I certify that on July 1, 2019, Maria Kaouris personally came before me, and this person acknowledged under oath, to my satisfaction, that:

- (a) This person is the Remediation Manager of Route 425/445 Route 440 LLC;
- (b) This person is the attesting witness to the signing of this document by the proper officer John Morris who is the Remediation Director of the Route 425/445 Route 440 LLC;
- (c) This document was signed and delivered by the limited liability company as its voluntary act and was duly authorized;
- (d) This person knows the proper seal of the limited liability company; and
- (e) This person signed this proof to attest to the truth of these facts.

Maria Kaouris
[Signature]

Maria Kaouris
[Print Name and Title of Attesting Witness]
Remediation Manager

Cheryl Lynn Toles, Notary Public
[Signature]

Cheryl Lynn Toles
[Print name]

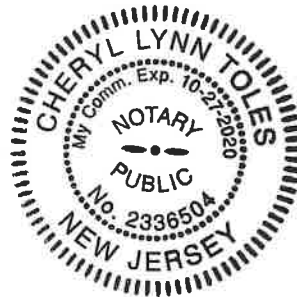

[Note: In situations where the person signing the document on behalf of the owner limited liability company is a member of the limited liability company, the attesting witness shall certify under oath that he/she knows that the document was signed and delivered by the owner limited liability company as its voluntary act, that the member is authorized to execute the document on behalf of the owner limited liability company, and that the person signing the document is authorized to sign the document on behalf of the member. Where the member is a partnership, corporation or other limited liability company, the attesting witness shall also certify that the person signing the document is authorized to sign on behalf of the corporation, partnership or limited liability company, as the case may be. To the extent that such corporation, partnership, or limited liability company, in turn, is directly or indirectly controlled by another corporation, limited liability company, or partnership, and the person signing the document is an officer of that corporation or limited liability company or a partner of that partnership, the attesting witness shall also certify under oath that such person is authorized to sign on behalf of the corporation, limited liability company, or partnership, as the case may be.]

WITNESS:

New Jersey Department of Environmental Protection

Bob Hoel
[Signature]

By: [Signature]
[Signature]

Robert J. Hoch Jr. Env. Spec III
[Print name and title]

Lynne Mitchell, Ass. Dir
[Print name and title]

STATE OF NEW JERSEY SS.:
COUNTY OF MERCER

I certify that on 9/18/19, Lynne Mitchell on behalf of the New Jersey Department Environmental Protection personally came before me, and this person acknowledged under oath, to my satisfaction, that this person:

(a) Is Asst. Director and is authorized to execute this document on behalf of the New Jersey Department of Environmental Protection;

(b) Signed, sealed and delivered this document as his or her act and deed in his capacity as Asst. Director of the New Jersey Department of Environmental Protection; and

(c) This document was signed and delivered by the New Jersey Department of Environmental Protection as its voluntary act, duly authorized.

Paige Robertson Notary Public
[Signature]
Paige Robertson
[Print name]
5000008767

PAIGE ROBERTSON
NOTARY PUBLIC OF NEW JERSEY
My Commission Expires 7/26/2022

RECORD AND RETURN TO:

Maria Kaouris
Honeywell
115 Tabor Road
Morris Plains, NJ 07950

Exhibit A
Metes and Bounds Description of Property

Block 21902, Lot 1 and Block 26704, Lot 5 (formerly Block 1289.5, Lot E)
City of Jersey City, New Jersey

Metes and Bounds Description

Real property in the City of Jersey City, County of Hudson, State of New Jersey, described as follows: All that certain Lot, piece or parcel of land, with the buildings and improvements thereon erected, situate, lying and being in the City of Jersey City, County of Hudson, State of New Jersey:

All those two certain pieces or parcels of land, being a part or portion of Grantor's property known as Branch No.1 identified as Line Code 0597 in Grantor's corporate records, also known as Block 21902, Lot 1 and Block 26704, Lot 5 (formerly Block 1289.5, Lot E) on City of Jersey City Tax maps, situate in the City of Jersey City, County of Hudson and State of New Jersey, separately bounded and described in accordance with a Plat of Survey prepared by Albert N. Faraldi, Professional Land Surveyor No. 29346, of Albert N. Faraldi Group, P.C., 854 Eight Street, Secaucus, New Jersey, dated August 10, 1988; as follows:

Tract I

Beginning at a point in the easterly line of New Jersey State Highway Route 440 distant 4.12 feet southerly from the State Highway Route 440 with the southerly line of Carbon Place (40 feet wide); and running thence (1) southerly along said New Jersey State Highway Route 440 on a curve to the left with a radius of 27.00 feet and an arc distant of 39.41 feet; thence (2) South 25°09' 35" West, 1,763.23 feet to a point of curvature; thence (3) still southerly and along said New Jersey State Highway Route 440 on a curve to the left with a radius of 1,237.57 feet and an arc distance of 580.19 feet to a point of tangency; thence (4) still southerly along said New Jersey State Highway Route 440 South 1° 42' 05" East, 816.38 feet to the northerly line of Danforth Avenue (70 feet wide); thence (5) South 32° 23' 37" East, 47.02 feet; thence (6) North 1° 42' 05" West, 855.39 feet to a point of curvature; thence (7) on a curve to the right with a radius of 1,213.57 feet and an arc distance of 568.94 feet to a point of tangency; thence (8) North 25° 09' 35" East, 1,790.06 feet, to the point of place of Beginning. Containing 78,016 square feet, or 1.791 acres, more or less.

Tract II

Beginning at a point formed by the easterly line of new Jersey State Highway Route 440 with the southerly line of Danforth Avenue (70 feet wide); and running thence (1) South 1° 42' 05" East, 290.86 feet; thence (2) South 80° 59' 02" East, 30.53; thence (3) North 1° 42' 05" West, 246.00 feet; thence (4) North 32° 23' 37" West, 58.77 feet to the point or place of Beginning. Containing 8,052.2 square feet, or 0.1848 of an acre, more or less.

Exhibit B

Exhibit B-1 (A through D): Restricted Area Map
Exhibit B-2: Tax Map

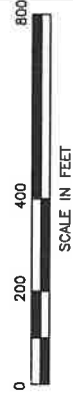
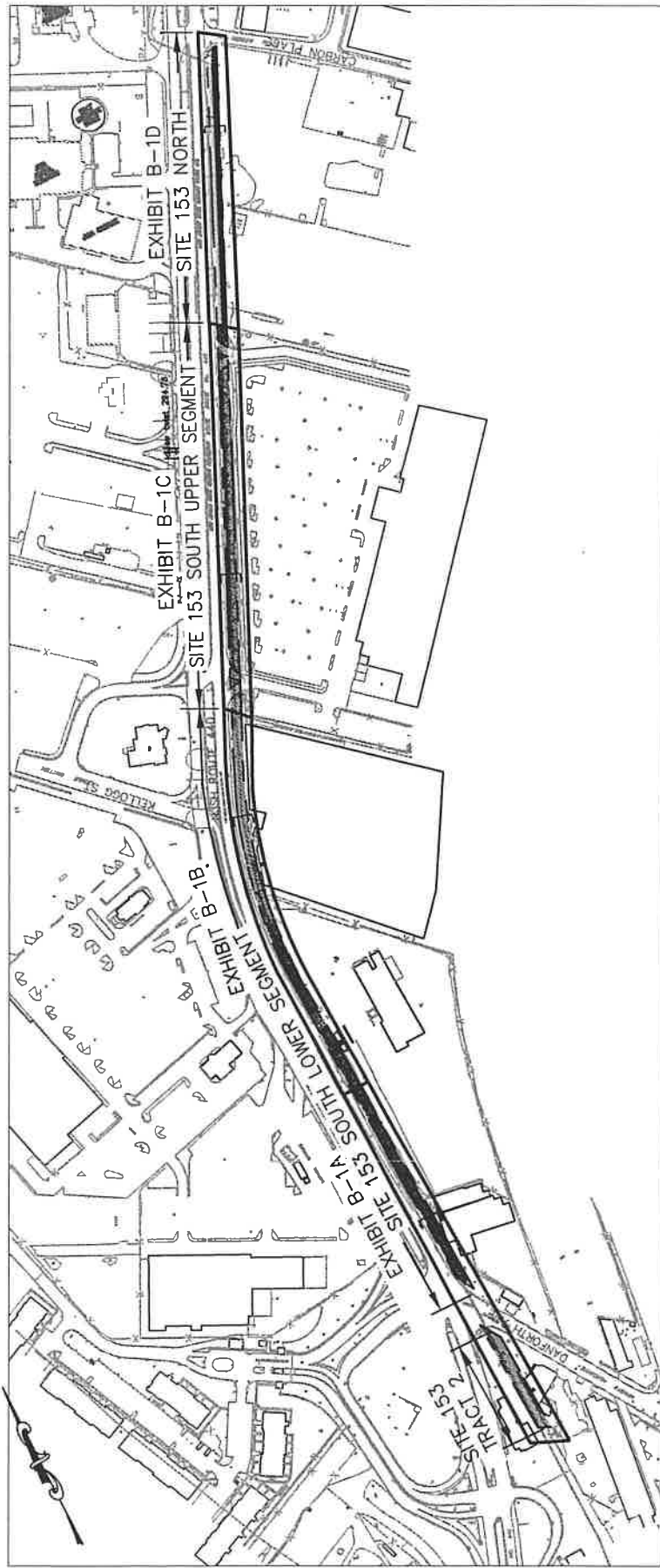

EXHIBIT B-1
RESTRICTED AREA MAP KEY
DEED NOTICE
BLOCK 21902, LOT 1 & BLOCK 26704, LOT 5
SA 5 - SITE 153 FORMER MORRIS CANAL
JERSEY CITY, NEW JERSEY

amec
ENVIRONMENT & INFRASTRUCTURE
200 AMERICAN METRO BLVD, SUITE 113
HAMILTON, NEW JERSEY 08619

AMEC PROJ No.: 3480110271
DRAWING: 3480110271-2100-B200-0000

PREPARED/DATE: STR 02/27/12	CHECKED/DATE: CMR 04/02/12
--------------------------------	-------------------------------

REV.	DATE	STATUS	BY	CHKD

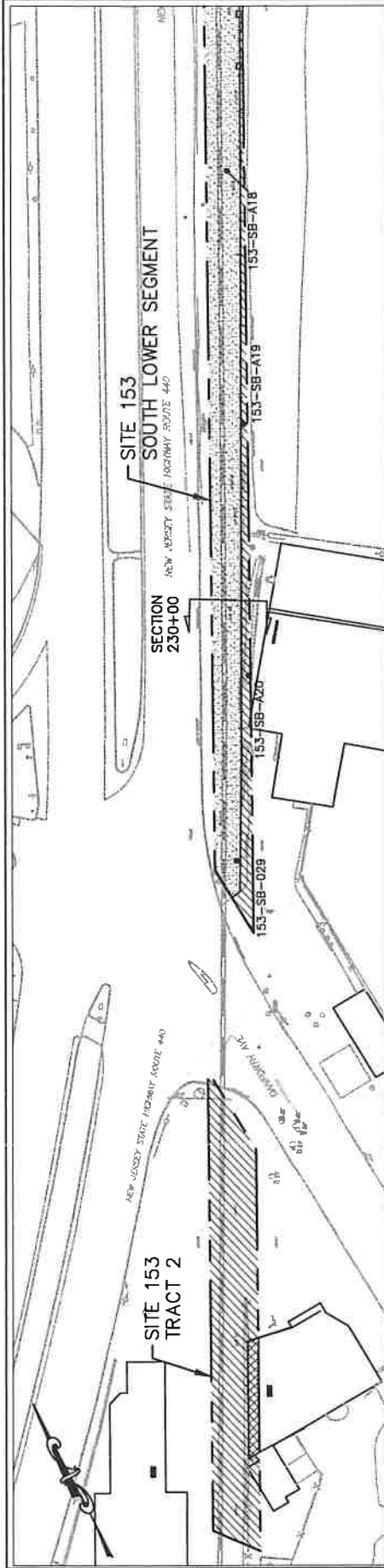

PLAN VIEW
SCALE IN FEET

LEGEND

- 153-SB-XXX
- SAMPLE LOCATION
- CROSS SECTION DIRECTION & LOCATION
- DEED RESTRICTION AREA
- BMUA FORCEMAIN
- PROPERTY LINE
- CENTERLINE STATIONING
- VEGETATED / SOIL CAP
- ASPHALT CAP
- CONCRETE CAP

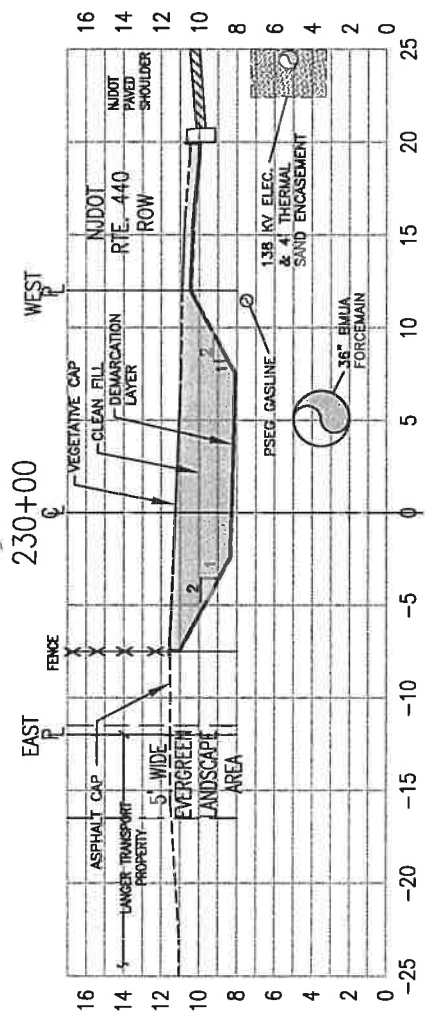

CROSS SECTION STA. 230+00
SCALE: 1"=10' HORIZONTAL
1"=1' VERTICAL

NOTES:
1. FURTHER DETAILS ON THE CAP CONSTRUCTIONS CAN BE FOUND IN THE INTERIM REMEDIAL ACTION PLAN SUBMITTED TO THE NJDEP ON OCTOBER 15, 2009 AND IN EXHIBIT C-2 (A)(2) OF THIS DEED NOTICE.

<p>AMEC PROJ No.: 3480110271 DRAWING: 3480110271-2100-8200-0000</p>		<p>EXHIBIT B-1A RESTRICTED AREA MAP SITE 153 SOUTH LOWER SEGMENT AND TRACT 2 DEED NOTICE BLOCK 21902, LOT 1 & BLOCK 26704, LOT 5 SA 5 - SITE 153 FORMER MORRIS CANAL JERSEY CITY, NEW JERSEY</p>
<p>PREPARED/DATE: STR 02/27/12</p>	<p>CHECKED/DATE: CMR 04/02/12</p>	
<p>REC'D DATE</p>	<p>DATE</p>	<p>STATUS</p>
<p>DRAWN BY</p>	<p>BY</p>	<p>BY</p>

ENVIRONMENT & INFRASTRUCTURE
200 AMERICAN METRO BLVD, SUITE 113
HAMILTON, NEW JERSEY 08619

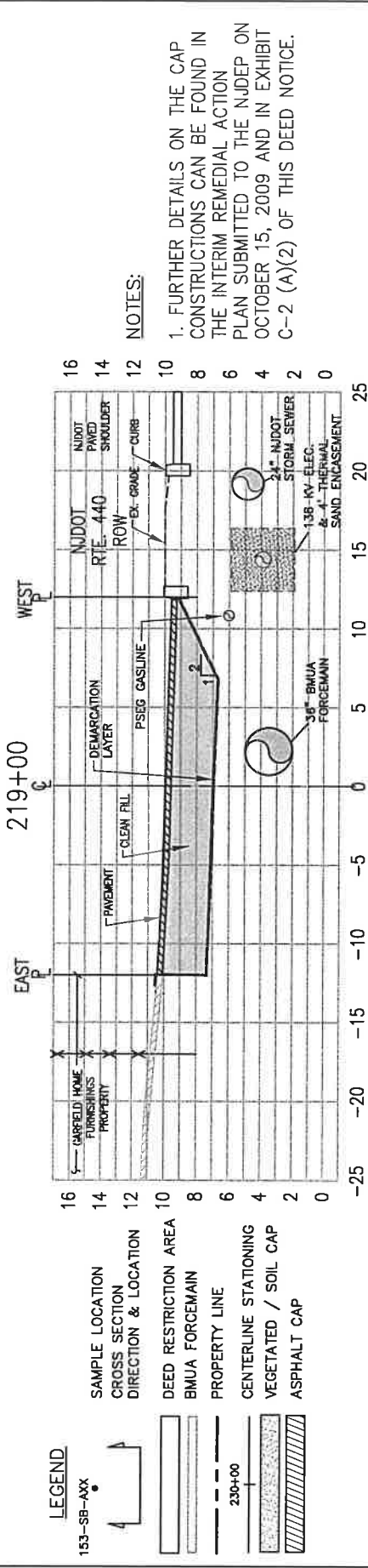
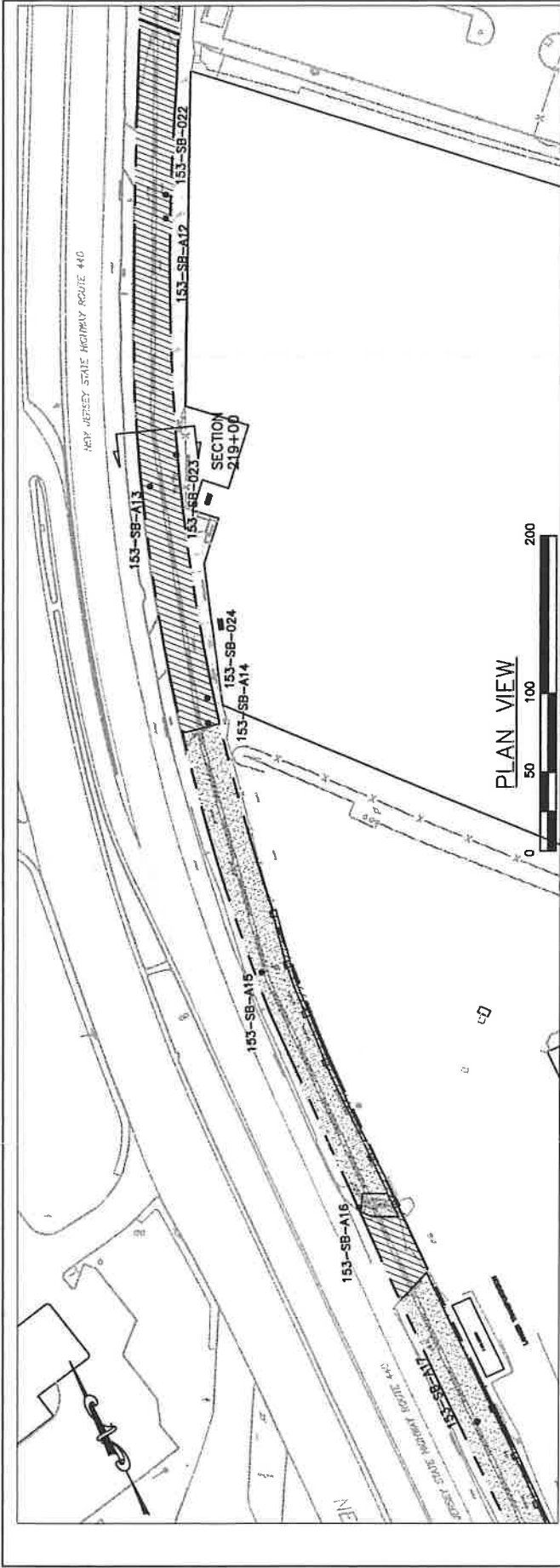

LEGEND

153-SB-AXX	●	SAMPLE LOCATION
▲	▲	CROSS SECTION DIRECTION & LOCATION
▭	▭	DEED RESTRICTION AREA
▭	▭	BMUA FORCEMAIN
▭	▭	PROPERTY LINE
▭	▭	CENTERLINE STATIONING
▭	▭	VEGETATED / SOIL CAP
▭	▭	ASPHALT CAP

NOTES:

- FURTHER DETAILS ON THE CAP CONSTRUCTIONS CAN BE FOUND IN THE INTERIM REMEDIAL ACTION PLAN SUBMITTED TO THE NUDEP ON OCTOBER 15, 2009 AND IN EXHIBIT C-2 (A)(2) OF THIS DEED NOTICE.

CROSS SECTION STA. 219+00
SCALE: 1"=10' HORIZONTAL
1"=1' VERTICAL

	AMEC	EXHIBIT B-1B RESTRICTED AREA MAP SITE 153 SOUTH LOWER SEGMENT DEED NOTICE BLOCK 21902, LOT 1 & BLOCK 28704, LOT 5 SA 5 - SITE 153 FORMER MORRIS CANAL JERSEY CITY, NEW JERSEY
	AMEC PROJ No.: 3480110271 DRAWING: 3480110271-2100-8200-0000 PREPARED/DATE: STR 02/27/12 CHECKED/DATE: CMR 04/02/12	ENVIRONMENT & INFRASTRUCTURE 200 AMERICAN METRO BLVD, SUITE 113 HAMILTON, NEW JERSEY 08619

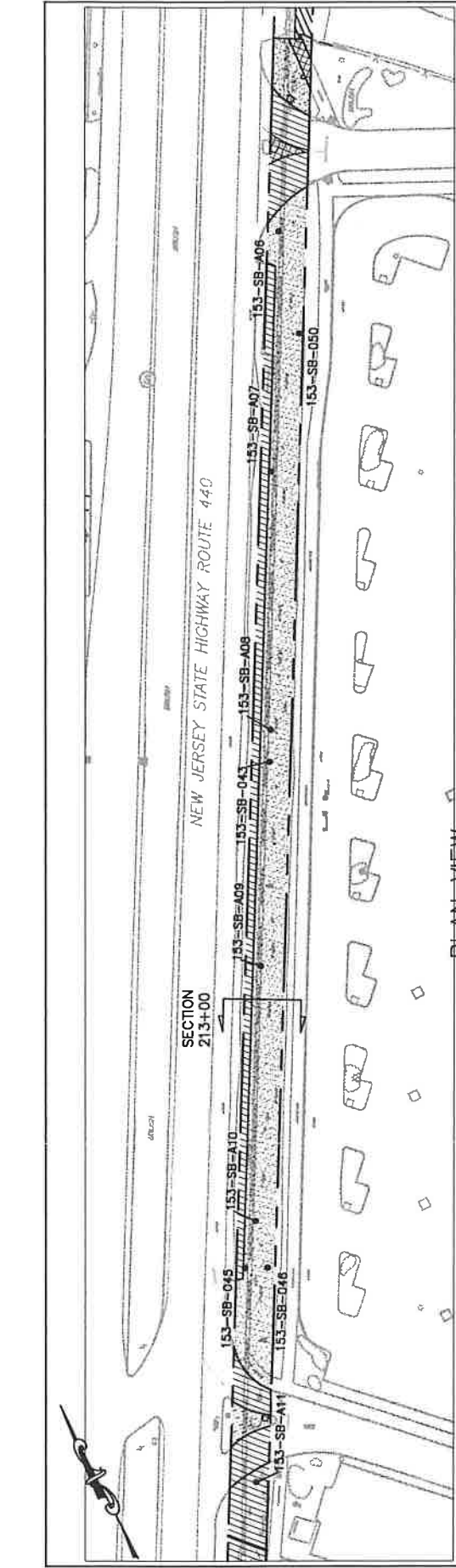

PLAN VIEW

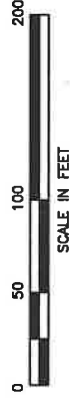

LEGEND

- 153-SB-XXX
- SAMPLE LOCATION
- CROSS SECTION DIRECTION & LOCATION
- DEED RESTRICTION AREA
- BMUA FORCEMAIN
- PROPERTY LINE
- CENTERLINE STATIONING
- VEGETATED / SOIL CAP
- ASPHALT CAP
- CONCRETE CAP
- MULCH CAP

NOTES:

1. FURTHER DETAILS ON THE CAP CONSTRUCTIONS CAN BE FOUND IN THE INTERIM REMEDIAL ACTION PLAN SUBMITTED TO THE NJDEP ON OCTOBER 15, 2009 AND IN EXHIBIT C-2 (A)(3) OF THIS DEED NOTICE.

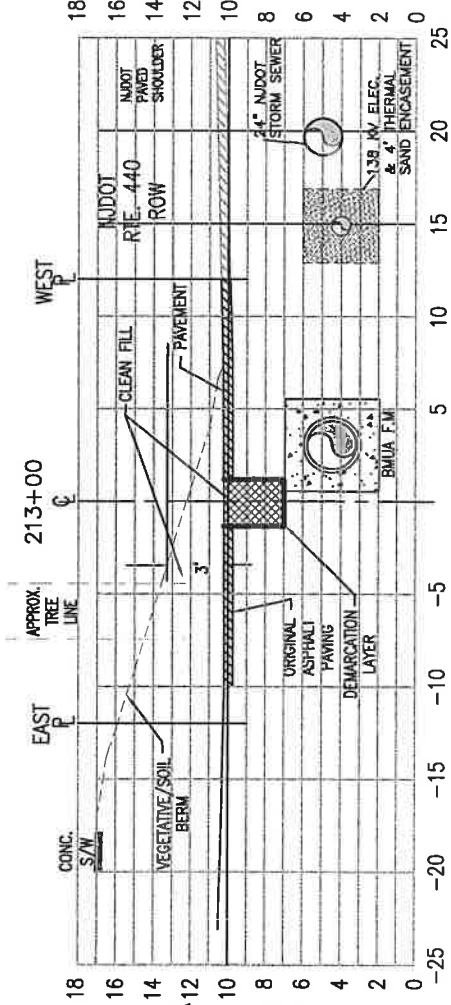

CROSS SECTION STA. 213+00

SCALE: 1"=10' HORIZONTAL
1"=1' VERTICAL

REV.	DATE	STATUS	DRFT	CHKD	BY

AMEC PROJ No.: 3480110271
DRAWING: 3480110271-2100-B200-0000
PREPARED/DATE: STR 02/27/12
CHECKED/DATE: CMR 04/02/12
ENVIRONMENT & INFRASTRUCTURE
200 AMERICAN METRO BLVD, SUITE 113
HAMILTON, NEW JERSEY 08619

EXHIBIT B-1C
RESTRICTED AREA MAP
SITE 153 SOUTH UPPER SEGMENT
DEED NOTICE
BLOCK 21902, LOT 1 & BLOCK 28704, LOT 5
SA 5 - SITE 153 FORMER MORRIS CANAL
JERSEY CITY, NEW JERSEY

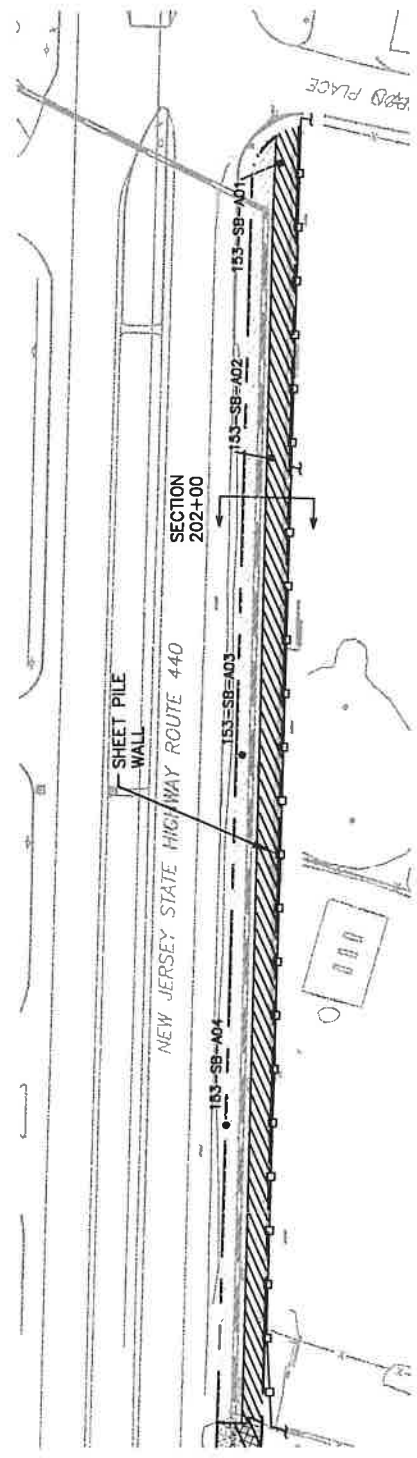

PLAN VIEW

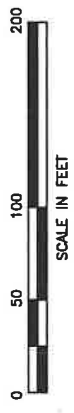

- NOTES:
1. DEPTH OF THE SHEET PILE WALL, LLDPE LINER, DEMARCATION LAYER AND BMUA FORCEMAIN VARY.
 2. THE LLDPE LINER AND DEMARCATION LAYER TERMINATES AT THE CONCRETE ENCASEMENT OF THE BMUA FORCEMAIN.
 3. THE WIDTH OF THE CONCRETE ENCASEMENT AROUND THE BMUA FORCEMAIN VARIES.
 4. LIMIT OF LLDPE LINER AND WALL ARE BASED ON AS-BUILT DRAWINGS PROVIDED BY KENNON SURVEYING SERVICES, INC. FURTHER DETAILS ON CAP CONSTRUCTION ARE PROVIDED IN THE REMEDIAL ACTION REPORT FOR THE SA-5 NJCU REMEDIATION PROJECT AND EXHIBIT C-2 (A)(1) OF DEED NOTICE.

- LEGEND
- 153-SB-AXX
 - SAMPLE LOCATION
 - CROSS SECTION DIRECTION & LOCATION
 - 6" OF ASPHALT PAVEMENT, ORANGE DEMARCATION LAYER AND LLDPE LINER AS ENGINEERING CONTROL
 - EXISTING PAVEMENT
 - BMUA FORCEMAIN
 - PROPERTY LINE
 - CENTERLINE STATIONING
 - ORANGE DEMARCATION LAYER & LLDPE LINER
 - SHEET PILE WALL

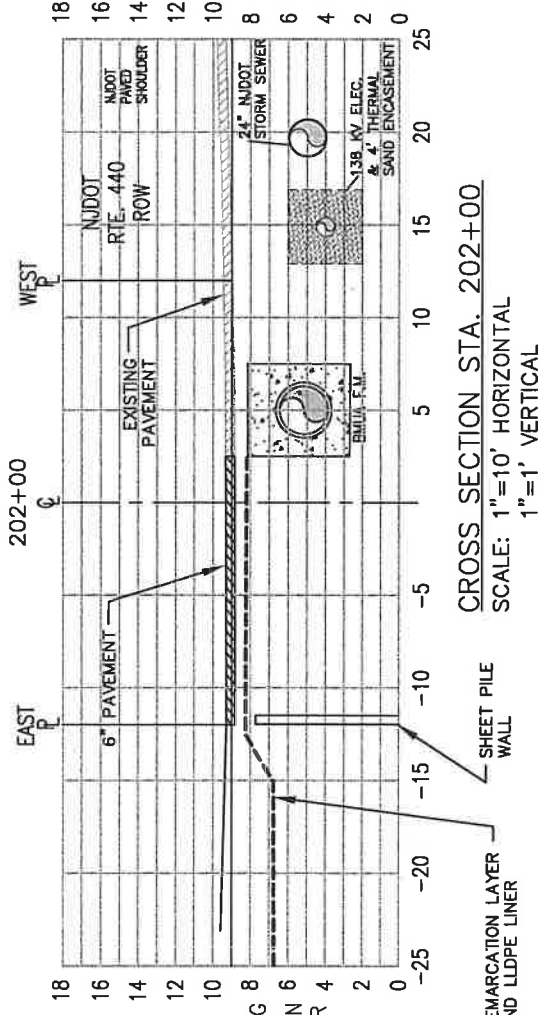

CROSS SECTION STA. 202+00
SCALE: 1"=10' HORIZONTAL
1"=1' VERTICAL

REV.	DATE	STATUS	DRN	CHKD	BY

AMEC PROJ No.: 3480110271	AMERICAN METRO BLDG, SUITE 113 HAMILTON, NEW JERSEY 08619
DRAWING: 3480110271-2100-8200-0000	ENVIRONMENT & INFRASTRUCTURE
PREPARED/DATE: STR 02/27/12	CHECKED/DATE: CMR 04/02/12

EXHIBIT B-1D
RESTRICTED AREA MAP
SITE 153 NORTH
DEED NOTICE
BLOCK 21902, LOT 1 & BLOCK 26704, LOT 5
SA 5 - SITE 153 FORMER MORRIS CANAL
JERSEY CITY, NEW JERSEY



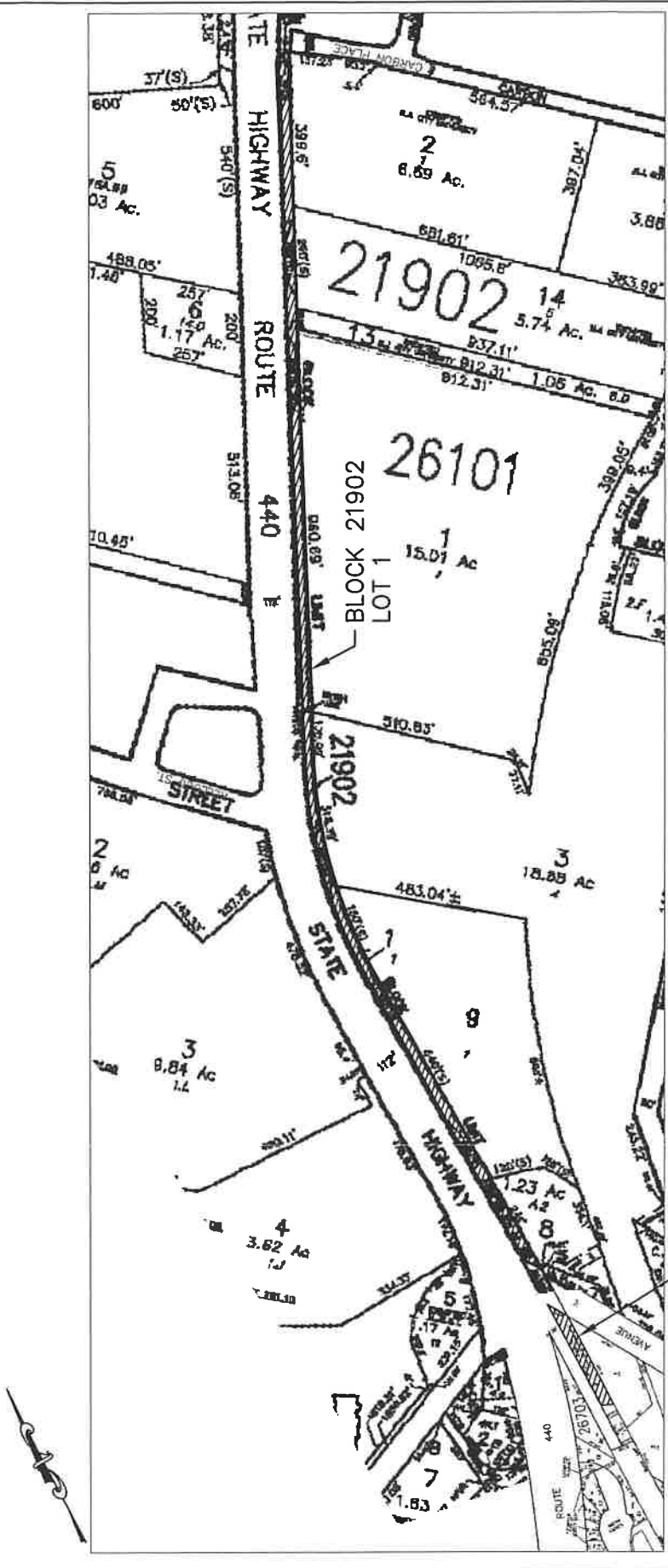

BLOCK 26704
LOT 5

SOURCE :
CITY OF JERSEY CITY TAX MAPS 219, 261 & 267,
DATED AUGUST 2006

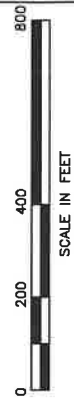

REV.	DATE	STATUS	DRPT	DRPD	BT

ameco
ENVIRONMENT & INFRASTRUCTURE
200 AMERICAN METRO BLVD, SUITE 113
HAMILTON, NEW JERSEY 08619

AMEC PROJ No.: 3480110271
DRAWING: 3480110271-2100-A2B0-0000
PREPARED/DATE:
STR 09/13/12
CHECKED/DATE:
CMR 09/13/12

EXHIBIT B-2
TAX MAP
DEED NOTICE
BLOCK 21902, LOT 1 & BLOCK 26704, LOT 5
SA 5 - SITE 153 FORMER MORRIS CANAL
JERSEY CITY, NEW JERSEY